

TACTILE MARKERS  
TRUNCATED DOMES

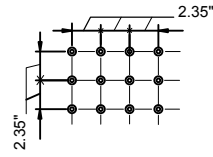

DETAIL "A"

TACTILE WARNING DETAILS  
INSTALLATION NOTES

THE TRUNCATED DOME SURFACE SHALL CONTRAST VISUALLY WITH THE ADJOINING WALKING SURFACES EITHER LIGHT-ON-DARK, OR DARK ON LIGHT. THE MATERIAL USED TO PROVIDE CONTRAST SHALL BE AN INTEGRAL PART OF THE TRUNCATED SURFACE.

RETROFIT INSTALLATIONS WILL NOT REQUIRE EXISTING DEPRESSED CURBING TO BE REPLACED. A NOMINAL 6 TO 8 INCH SETBACK FROM FACE OF CURB SHALL BE ENFORCED FOR NEAR EDGE OF TACTILE DOMES.

COST OF INSTALLATION AND MATERIALS FOR TACTILE WARNING DEVICES SHALL BE INCLUDED IN THE PRICE BID OF THE RAMPS AND SIDEWALKS.

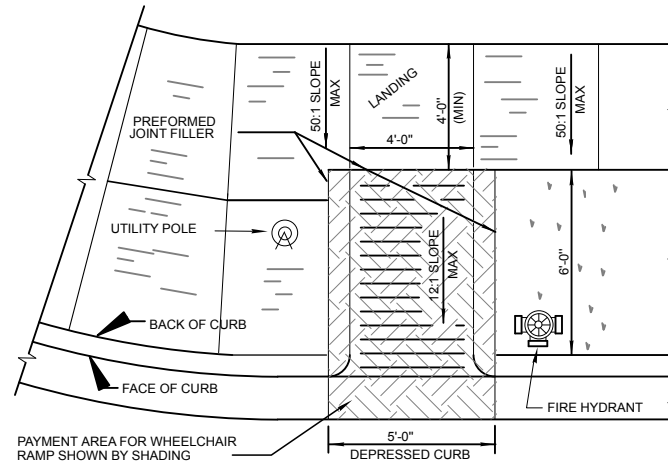

TYPE "B" RAMP  
Plan

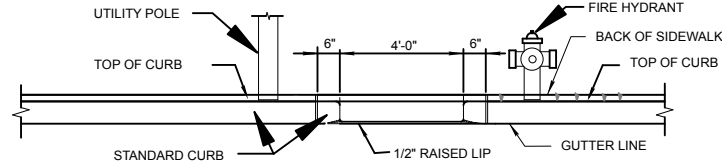

ELEVATION

OBSTRUCTION RAMPS  
TYPE "B" RAMP

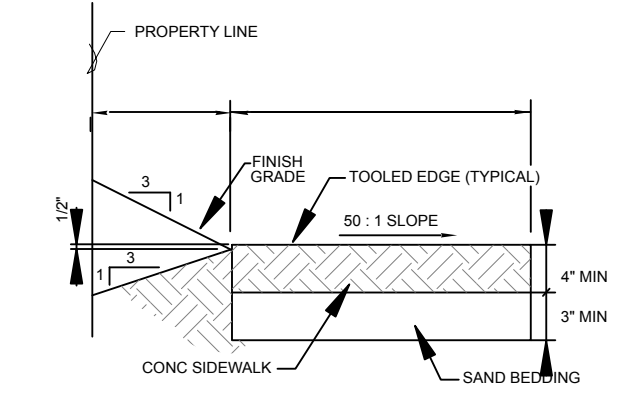

SECTION

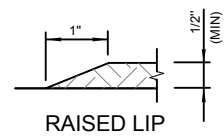

RAISED LIP

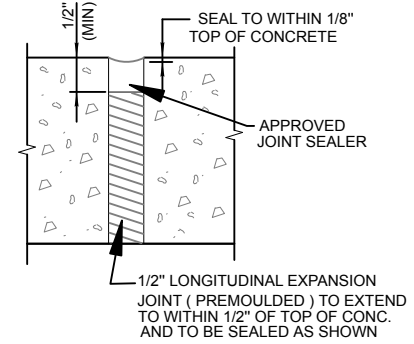

1/2" EXPANSION JOINT

JOINT FILLER SHALL MEET THE REQUIREMENTS OF SECTION 701.08b AND 701.08e.

EXPANSION JOINT SHALL BE USED BETWEEN SIDEWALK AND CURBS, WHEELCHAIR RAMPS, DRIVEWAYS, STREETS, RETAINING WALLS, ETC.

:STANDARD DETAIL\STREET\STRT-17.DWG

1. THE TEXTURE ON THE RAMP SURFACE SHALL BE ROUGHER THAN THE TEXTURE USED ON THE SURROUNDING SIDEWALK.
  - A. IN ALL CASES A RAMP SHALL HAVE A WOOD FLOAT OR ROUGHER FINISH.
  - B. IN SIDEWALKS CONSTRUCTED WITH TERRAZO, PAVERS (BRICK, TILE, OR GRANITE BLOCK) OR ANY OTHER SPECIAL SURFACE, THE RAMPS SHALL BE CONSTRUCTED OF A MATERIAL WITH ROUGHER TEXTURE.
2. CORREGATIONS IN RAMPS SHOULD BE AVOIDED SINCE THEY CAN HOLD WATER IN FREEZING WEATHER AND BECOME ICY.
4. SPECIFIC LOCATIONS MUST BE APPROVED BY ENGINEER.

5. THE ABOVE EXAMPLES ARE TYPICAL ONLY AND ARE SHOWN TO ILLUSTRATE POSSIBLE RAMP TYPES, POSSIBLE RAMP LOCATIONS, POSSIBLE INLET LOCATIONS, AND HOW THE RAMP WILL BE DESIGNATED ON THE PLANS. CARE SHOULD BE EXERCISED TO ASSURE THAT MEDIAN RAMP AND CURB RAMP LINE UP, AND THAT RAMPS THROUGHOUT A PROJECT ARE LOCATED WITH SOME DEGREE OF UNIFORMITY.
6. USE TYPE "B" RAMP WHEN OBSTRUCTIONS, WHICH ARE NOT TO BE REMOVED, ARE ENCOUNTERED ON EITHER SIDE OF WHEELCHAIR RAMPS.



REVISION	BY	DATE	<b>CURB RAMP (H/C) TYPE B RAMP</b> STANDARD DETAILS	
			CITY OF OWASSO, OKLAHOMA	
			PUBLIC WORKS DEPARTMENT ENGINEERING DIVISION	
			DATE: 05/05	STANDARD NO. STRT-17